

When new materials are used in buildings it is important to consider different sources. Recycled content in building materials will reuse waste products that would otherwise be deposited in landfills. The use of local materials supports the local economy and reduces the impacts of transportation. Over the past decade an increasing number of public and private waste management operations have begun to reduce construction debris volumes by recycling and reusing these materials. Recovery and recycling activities typically involve job site separation into multiple bins or disposal areas.

CONSIDERATIONS

Building material choices are important in green building design because of the extensive network of extraction, processing and transportation steps required to process them. Activities associated with the production of building materials pollute the air and water, destroy natural habitats and deplete natural resources. The construction industry consumes approximately 40% of the global material flow and generates about 33% of the North American solid waste stream. Materials found in the waste stream should be viewed as resources or commodities rather than waste.



BUILDING PERSPECTIVE

Forest Stewardship Council (FSC) certified materials were used for a variety of different wood building components, including glulam timber beams and interior doors.

Recycled materials installed in the facility include the reuse of exiting large barn board and wood beams that were re-milled and used in the main atrium ceiling and boardroom table.

MATERIALS AND RESOURCES

New materials used in the building contain high amounts of recycled content, some as high as 90%. Several building materials and products that are extracted and manufactured within the region were used in construction supporting the use of indigenous resources and reducing environmental impacts resulting from transportation. These materials have 80% of their mass extracted, processed and manufactured within 800 km of the project site if transported by truck, other materials were sourced within 2400 km if transported by railroad or boat.

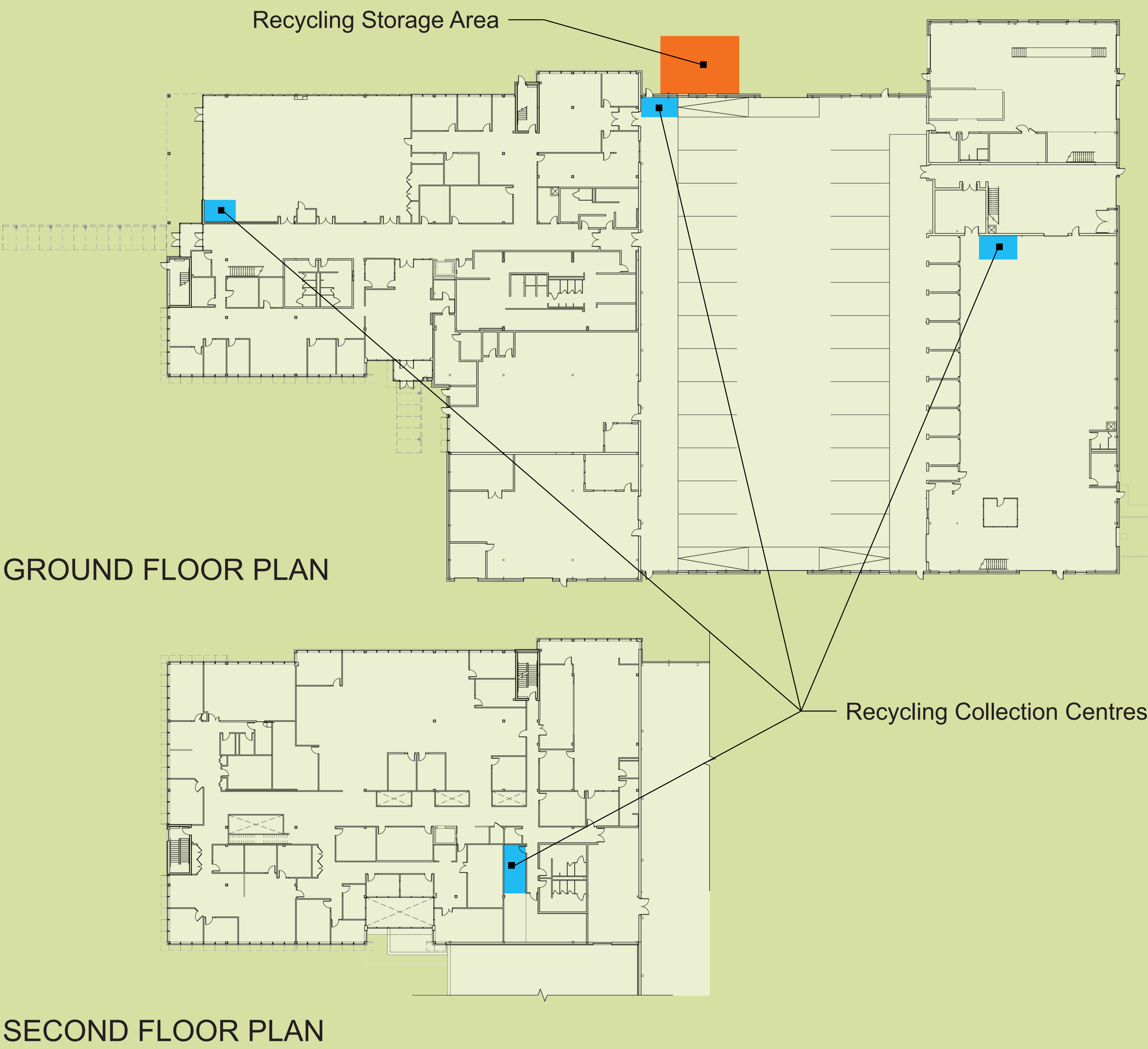

GREEN MEASURES

- A comprehensive construction waste management program was implemented throughout the project to divert over 75% of all construction waste. Material bins were placed on site throughout construction and labelled for all construction crews to observe.
- The disposal methods deployed include the shipment of dedicated plastic and paper to a recycling facility, the delivery of drywall-filled containers to a recycling facility, and the relocation of clean fill for re-use.
- Recycling depots have been located throughout the building and the building occupants will continue their already aggressive recycling program to re-use as much material as possible and to divert most waste from landfill.